

Manufacturing & Engineering

Sector Proposition

»LOCATE
EAST SUSSEX



A close-up photograph of an architectural drawing, likely a floor plan, featuring blue ink lines and various annotations. A wooden ruler is positioned diagonally across the upper right portion of the drawing, and a yellow pencil with a green and pink eraser is placed diagonally across the lower left. A dark purple rectangular box is superimposed over the center of the image, containing the word 'Contents' in white text. The drawing includes labels such as 'MEN 128', '18'-4"', 'A3.1', 'A2.4', '129', '126', '125', '13'-7"', '13'-8"', '123', '122', '121', '120', '119', '118', '117', '116', '115', '114', '113', '112', '111', '110', '109', '108', '107', '106', '105', '104', '103', '102', '101', '100', '99', '98', '97', '96', '95', '94', '93', '92', '91', '90', '89', '88', '87', '86', '85', '84', '83', '82', '81', '80', '79', '78', '77', '76', '75', '74', '73', '72', '71', '70', '69', '68', '67', '66', '65', '64', '63', '62', '61', '60', '59', '58', '57', '56', '55', '54', '53', '52', '51', '50', '49', '48', '47', '46', '45', '44', '43', '42', '41', '40', '39', '38', '37', '36', '35', '34', '33', '32', '31', '30', '29', '28', '27', '26', '25', '24', '23', '22', '21', '20', '19', '18', '17', '16', '15', '14', '13', '12', '11', '10', '9', '8', '7', '6', '5', '4', '3', '2', '1', '0'.

Contents

Contents

1. Overview
2. Drivers for growth
3. Why East Sussex
4. East Sussex opportunities
5. Skills & Innovation
6. Manufacturing & Education
7. Vacuum
8. Instruments
9. Pumps
10. Food & Drink
11. Locate East Sussex
- Case studies**
12. Focus SB
13. Torr scientific
14. Scientifica

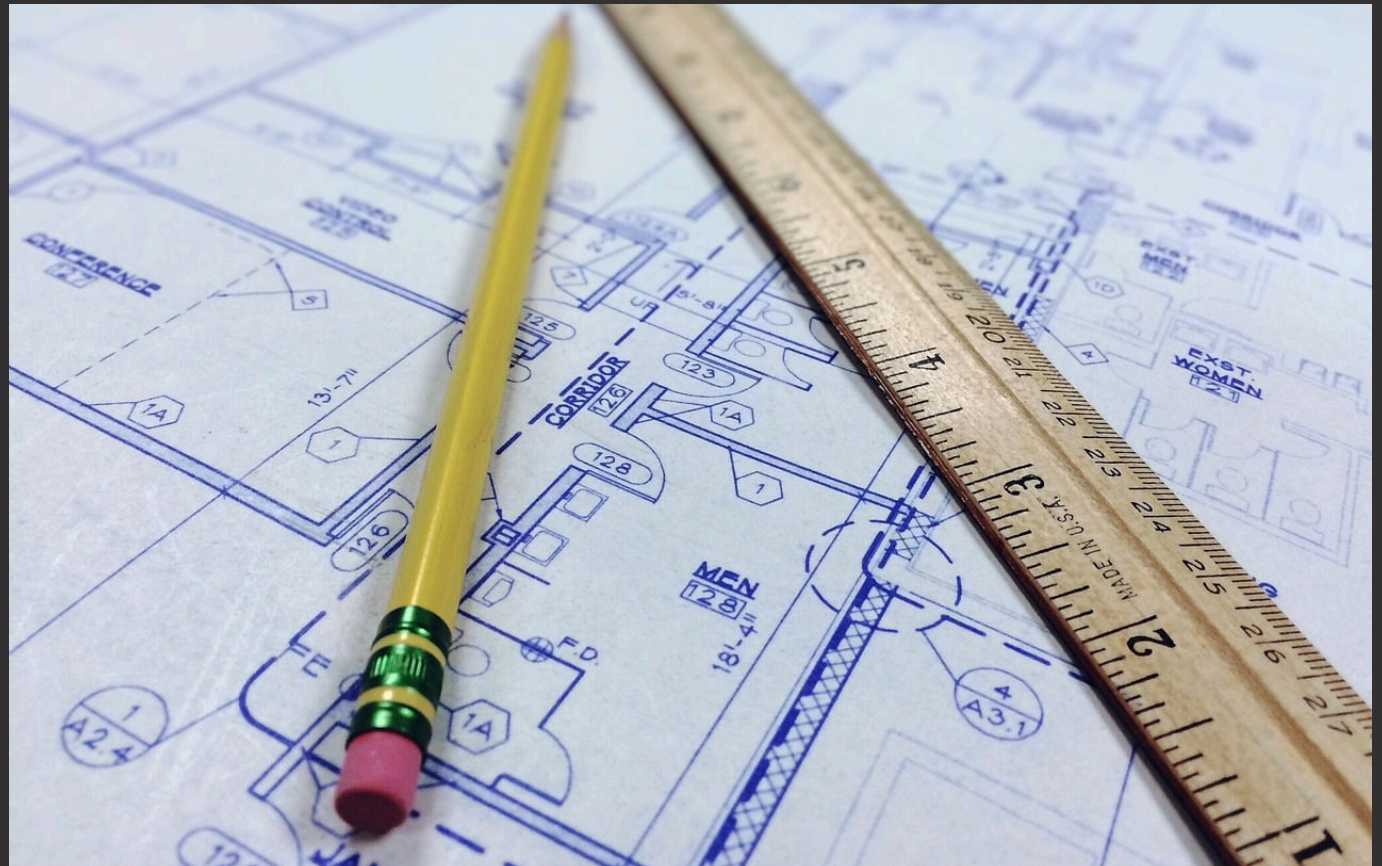

Overview



OVERVIEW

The UK is the **9th largest manufacturing nation in the world**, and despite uncertainty around the UK leaving the European Union, engineering and manufacturing in the UK is strong.

The UK's engineering and manufacturing sector is comprised of thousands of companies and a supply chain dedicated to delivering precision products and specialist services. The UK can boast a thriving manufacturing sector with investment in automation and technological advances adding up to **£275bn to the national economy each year**.

East Sussex has over 1200 companies in the manufacturing and engineering sectors and employs over 18,000 people making up 9.9% of the counties total workforce.*

INNOVATIONS

The UK invests heavily in R&D initiatives, encouraging innovation in key industrial areas such as sustainable manufacturing, clean energy, efficient and integrated transport, health and wellbeing, materials and resource efficiency and food security.

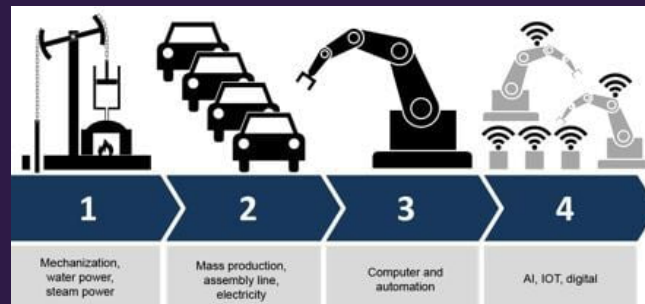

The UK's engineering sector adds £275bn to the national economy each year.

OPPORTUNITIES

New technologies and the advent of **Industry 4.0** are set to transform productivity in the next few years. Industry 4.0 is the expected growth in automation and data exchange in manufacturing technologies and processes. The World Economic Forum considers the UK a leading country for Industry 4.0 – ranked 2nd for technology and innovation, and 1st for available financing.

Part of the UK's Industrial Strategy – The Made Smarter Review – has provided recommendations designed to help transform the landscape for UK manufacturing by advising and promoting the adoption of the Industry 4.0 technologies.

The High Value Manufacturing Catapult has greatly accelerated the development of new manufacturing technologies and engineering.

In short, UK manufacturing and engineering is poised for great things and many of these will be happening in East Sussex.

- **SOURCE:** <https://www.great.gov.uk/international/content/about-uk/industries/engineering-and-manufacturing/>
- **SOURCE:** East Sussex in figures <http://www.eastsussexinfigures.org.uk/webview/welcome.html>

Drivers for growth



DRIVERS FOR GROWTH

Digital manufacturing and greater resource efficiency are transforming the needs of UK manufacturers and creating opportunities to supply new products and services into the market. Local Manufacturing in the UK is expected to increase as a result of COVID-19 and Brexit.

DIGITAL UPGRADES

Manufacturers looking to upgrade existing machinery to more digitally enabled technology.

Opportunities include:

- Sensors
- Smart metering and monitoring
- Connectivity hardware
- Cloud solutions for integrating the supply chain
- Data analytics

SMART MANUFACTURING

There is increased demand for new machinery and equipment due to the drive for more efficient production and greater customisation.

Opportunities include:

- Robotics and automation
- 3D printing
- Smart equipment
- Modern CRM & ERP systems
- IIOT platforms and hosting

EMERGING TECHNOLOGIES

Demand from UK manufacturers looking to integrate technology into their production, results in the emergence of a new Industrial Internet of Things supply.

Opportunities include:

- Sensors
- Data analytics,
- Artificial Intelligence,
- Low Power Wan technology

ENERGY AND RESOURCE EFFICIENCY

The demand for sustainability means manufacturers desire more efficient equipment, with better monitoring and easy maintenance, ensuring it lasts longer.

Opportunities include:

- Energy efficiency and decarbonisation
- Predictive maintenance and digital twin technology
- Energy monitoring
- AI and data analytics
- Connected devices

- **SOURCE:** <https://www.great.gov.uk/international/content/about-uk/industries/engineering-and-manufacturing/>
- **IMAGE:** Laymik, credit the Noun Project

Why East Sussex?



WHY EAST SUSSEX?

East Sussex offers an ideal location for business to innovate and grow.

East Sussex is urban, coastal and rural. Close enough to London and Brighton to enjoy all the benefits but far enough away to escape the city. The whole of East Sussex is less than two hours from London, the north of the county is less than an hour. Global markets can be accessed via Gatwick, the Channel Tunnel and Newhaven Port.

With a population of just over half a million, East Sussex covers an area of 1,725 square kilometres (660 square miles.)

AFFORDABLE LIVING AND LOW OPERATING COSTS

Larger living and commercial property and studio space are surprisingly affordable compared to many parts of the South East. This is attracting enterprises looking to create jobs, not just for themselves, but for others helping to support jobs in local communities

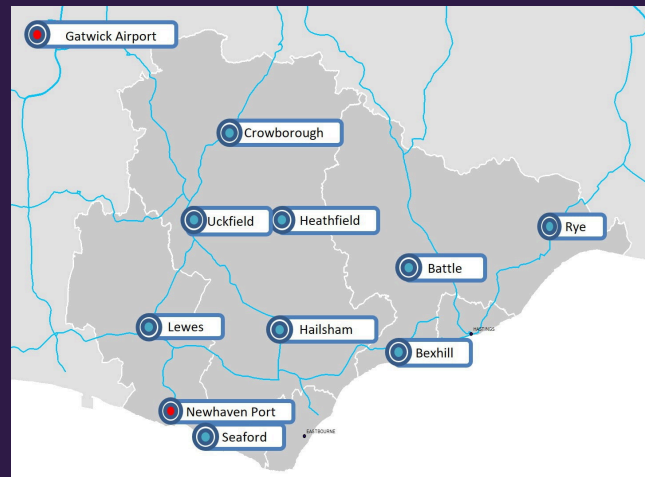

TALENT AND ACADEMIC LINKS

Internationally renowned universities and colleges provide a rich supply of apprentices and graduates across a range of disciplines. Connect with ground-breaking researchers impacting real-world problems such as the ageing-population, disease and climate change and access the next generation of talent.

INNOVATION DESTINATION

New industries are supporting the old; technology is reconnecting our communities and the next pioneering generation of innovators are finding fresh relevance in seaside towns. Access a deep pool of knowledge, immerse yourself in a rapidly growing digital culture, access funding and test out your ideas with a sophisticated set of customers on your doorstep.



UNBEATABLE WORK-LIFE BALANCE

There is a breath of fresh air for businesses in East Sussex. With a vibrant cultural scene and surrounded by nature, we know quite a bit about balancing work and life. Here you can escape the stresses of everyday and make work fit around your lifestyle and commitments or balance family and your career - all are possibilities in East Sussex.



DIGITALLY CONNECTED

Technology is transforming our lives and enabling professionals and entrepreneurs to choose where they work. Superfast broadband with excellent coverage makes working remotely and commuting to the city for client meetings, more than feasible.





East Sussex opportunities

EAST SUSSEX OPPORTUNITIES

COMMERCIAL SPACE

From coworking and incubation spaces to state-of-the-art industrial estates and business parks, commercial property in East Sussex is surprisingly affordable compared to other parts of the South East. The right location and premises can be critical to attracting customers and employees.

Newhaven Enterprise Zone

Key growth hub for the South East

With opportunities for bespoke development, business rate relief and no pre-application charges for planning enquiries, Newhaven is a place with great potential for businesses to succeed.

Newhaven offers substantial physical capacity for growth. Comprising eight sites, Newhaven Enterprise Zone covers approximately 79 hectares, offering space to house the region's expanding high-growth businesses and excellent access to domestic and international markets. London is just 90-minutes away by train and Brighton is only 30 minutes by car or train.





Connect 27 Business Park
Polegate

- New scheme of 22 industrial / warehouse units
- Ready for occupation
- Convenient and attractive location at the Junction of the A27 & A22



Eastside Business Park
Newhaven

- New scheme of business units in the Newhaven Enterprise Zone.
- Benefits can include a business rates discount over a 5 year period.
- Available for immediate occupation



Rye Wharf
Rye

- Sites are available from 1,000 sq. ft to 100,000 sq. ft.
- Wharfage for ships up to 300 ft. Manned 24 hour security.



Phase 2 Swallow Business Park **Hailsham**

- The site is prominently located with direct access to the A22, approximately 1.5 miles west of Hailsham.
- 3216 to 6432 sq. ft units available



Chaucer Business Park **Polegate**

- 2450 sq ft units in an excellent location that well connected by road and rail
- The site in positioned on the outskirts of Eastbourne and Polegate, close to the A27 bypass



Ashdown Business Park **Uckfield**

- Variety of different sized office and light industrial units
- Located in the heart of East Sussex affording easy access to a variety of major towns

Skills & Innovation



SKILLS AND INNOVATION



Created by Alice Design
from Noun Project

£3.4bn

committed for innovation up to 2021

The UK has a thriving Infrastructure for research and development. Government and industry are offering funding for research into fast-growing and sustainable market ideas.

This is backed by a network of Centres of Excellence that can help commercialise innovation.

LOCAL UNIVERSITIES

East Sussex is well served for higher education, with the following campuses within the area:

- [University of Sussex](#)
- [University of Brighton](#)
- [East Sussex College Group](#)
- [Plumpton College](#)
- [Sussex Innovation Centre](#)

The business incubation network located at the University of Sussex, supports entrepreneurs, start-ups and scale-ups across the South East.



Give an hour...
change a life

THE CAREERS &
ENTERPRISE
COMPANY

Introduce a young person to
an exciting career that they
don't even know exists.

**GIVE AN
HOUR**

Find out more >

ADVANCE ENGINEERING CENTRE

The Advanced Engineering Centre (AEC) is an internationally-recognised centre of research excellence with an established track record of pioneering research at the University of Brighton. This is a £14 million investment into cutting-edge facilities needed to tackle the most pressing engineering challenges.



FUTURE SKILLS

With grants available for STEM education in schools in Sussex, **investment into the advanced engineering sector is ongoing in the region.**

The East Sussex Careers Hub brings together 40 secondary schools, colleges and special schools, 24 primary schools, alongside employers and other partners to bring forward careers education across the county.



EAST SUSSEX COLLEGE GROUP

With campuses located across East Sussex, the East Sussex College Group in Hastings offer an Engineering and Manufacturing T Level. Students on the course are able to develop an understanding of a broad range of issues relevant to the sector such as the materials and their process/process, essential mathematics for engineering and manufacturing, and basic commercial principles

Manufacturing & Engineering



EAST SUSSEX OVERVIEW

East Sussex is in the second largest region in the UK for output and employment in the manufacturing sector* making East Sussex an ideal location for innovative and forward thinking businesses to be located.

Manufacturing and engineering makes up 8.8% of the counties GVA (gross value added) making it one of the largest sectors in the county.

Manufacturing and Engineering in East Sussex are particularly strong in the following sectors:

Vacuum
Pumps
Instruments
Food & Drink



INNOVATION

As technology continues to develop and enhance all aspects of business, engineering is helping the manufacturing sector find more efficient and sustainable ways of working.

Manufacturing and engineering is seeing demand for increasingly innovative products that **work faster, smarter and better** than ever before thanks to rising consumer knowledge.

East Sussex businesses are well placed to respond to this demand with world leading and innovative companies such as [Surrey Nano Systems](#) the producers of Vantablack. This product is used across a range of industries including space and technology, optics and lens systems and the automotive sector.

INTERNATIONAL LINKS

East Sussex already plays host to a number of major international companies. Trifast PLC with its headquarters in Uckfield, designs, manufactures, and distributes mechanical fasteners to the automotive sector on a global basis.

General Dynamics which designs, manufactures and engineers for the defence market around the world and has sites internationally has production facilities in Hastings.

Servomex which established a global presence with the opening of business, service and systems engineering centres based in Shanghai, China; Houston, Texas; Netherlands; Mumbai, India; São Paulo, Brazil; Singapore, has its state-of-the-art Technical Centre in Crowborough.

Gunnebo, a global provider of security products, services and software with sites in over 25 different territories has R&D facilities in Uckfield.



Vacuum

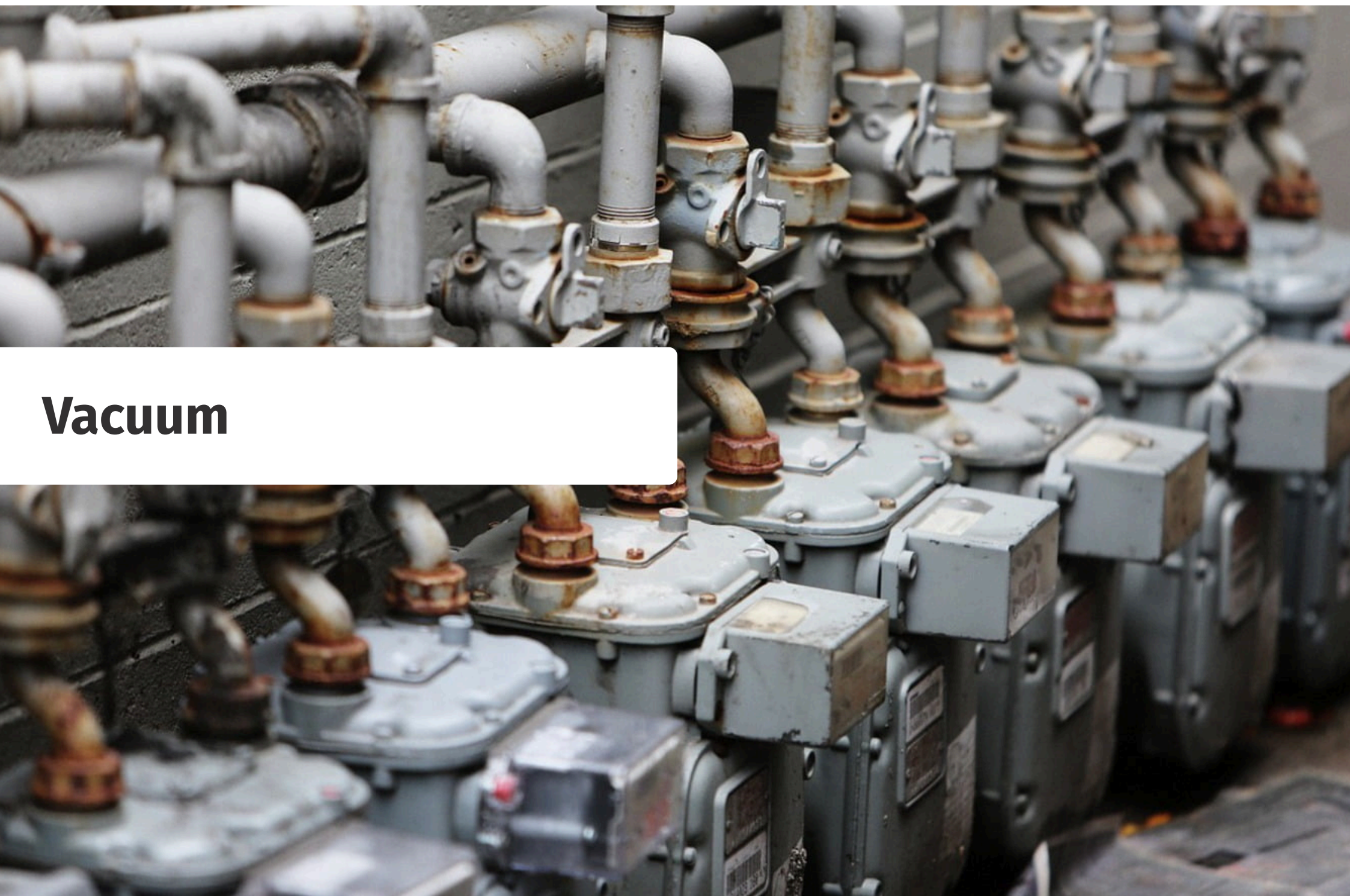

VACUUM

There is a significant cluster of Ultra High Vacuum (UHV) businesses in East Sussex. In addition, there are many manufacturing sub-contractors involved in the supply of components for High Vacuum manufacturers. 8% of the working population in Hastings works within the manufacturing sector.



EAST SUSSEX SUCCESS STORIES

Hailsham based VACGEN manufactures ultra-high-quality vacuum products boasting over 50 years' experience in research and science. The Sussex company is responsible for creating some of the most advanced vacuum research systems in the world.

HT Products based just outside Hailsham - is a specialist manufacturer within the Scientific Vacuum Industry. HTP offers a full service for supply of UHV systems and vacuum processing systems from design and consultancy through to manufacture and testing, to delivery and commissioning of a full turnkey UHV system.

Vacuum Services is vacuum product supplier and manufacturing facility based in Hastings. The company offers a complete solution for lab or factory. By controlling all processes from raw material to finished components, Vacuum Services has complete control of the manufacturing procedure, and can therefore offer better lead times than its competitors.

Eastbourne based SS Scientific is involved in the design, manufacture and distribution of precision components and instrumentation for the vacuum industry.

Kurt J Lesker has had its European Headquarters in Hastings since 1991 and is one of the leading suppliers and creators of high-quality vacuum systems and products globally, creating technology that makes the modern world that we live in exist today.

UHV Design based near Lewes specialise in the design, manufacture and supply of innovative market-leading HV and UHV motion and heating products supplying globally.

Instruments

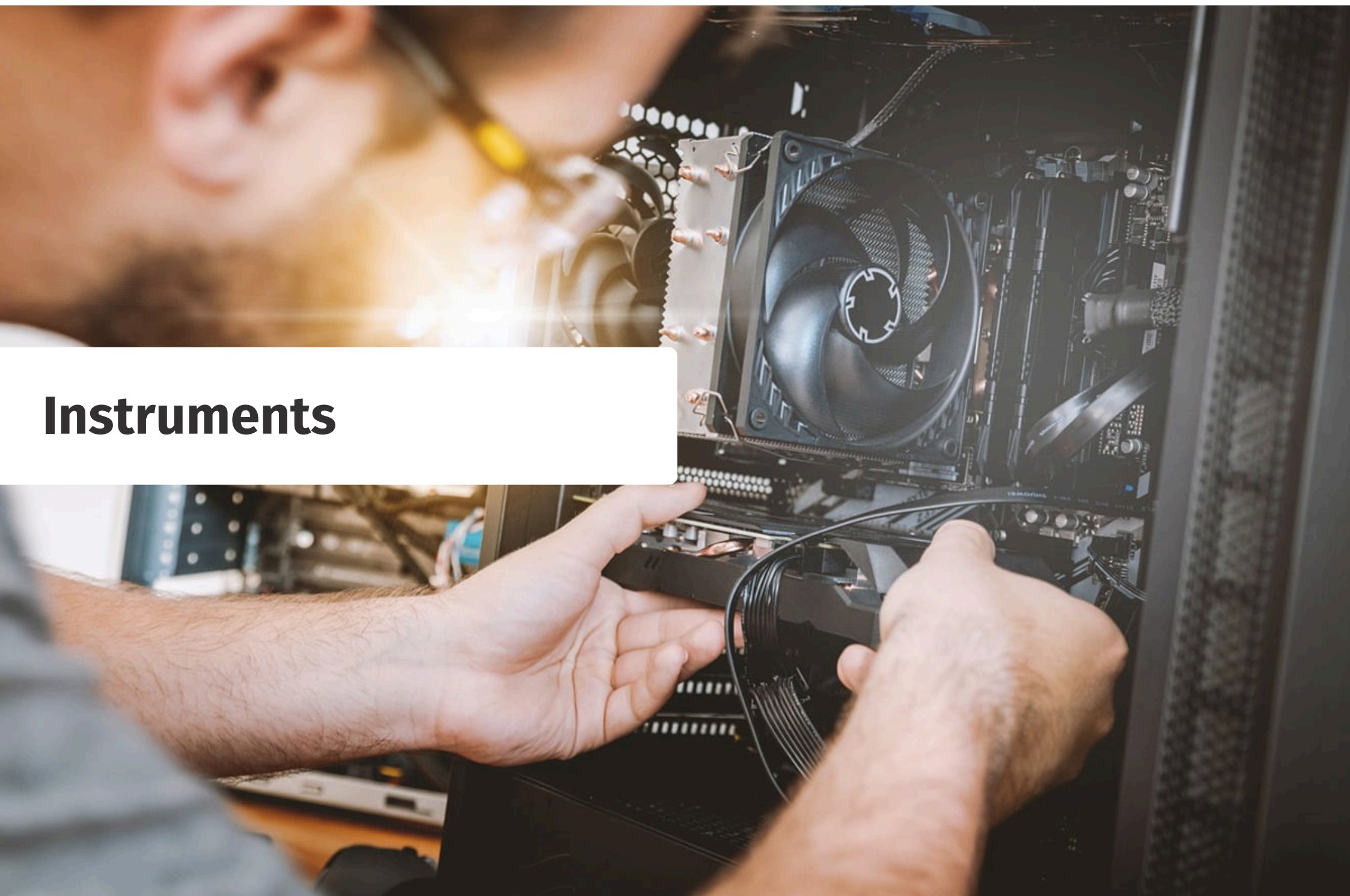

INSTRUMENTS

Sussex is home to a number of instrument manufacture specialists which supply equipment into many different sectors ranging from Life Science and Healthcare to Aerospace.



EAST SUSSEX SUCCESS STORIES

Pion – A US owned company located at Forest Row, is a science-based company providing innovative technology, solutions, support and scientific expertise to the drug development industry.

Based in Crowborough Servomex is a world leader in the development and productions of advanced instruments and test equipment for use in gas analysis in a range of industries.

Data Physics designs and markets high-performance test and measurement solutions for applications in noise and vibration around the world from its offices in Hailsham.

Uckfield based Scientifica specialises in providing cutting-edge equipment optimised for electrophysiology, multiphoton imaging and optogenetics research.

From its UK base Scientifica manufactures and distributes high-quality instruments to universities, pharmaceutical companies and research laboratories in more than 40 countries worldwide.

Ate AEROTECH has a 35 year history providing aerodynamic test equipment for wind tunnel testing as well as supplying state of the art test and robotic equipment for a myriad of other complex engineering applications, from its Heathfield base.

Ate AEROTECH supports its client's work in the educational, research, industrial, automotive, motorsport, aerospace and defence sectors across the globe.

Pumps

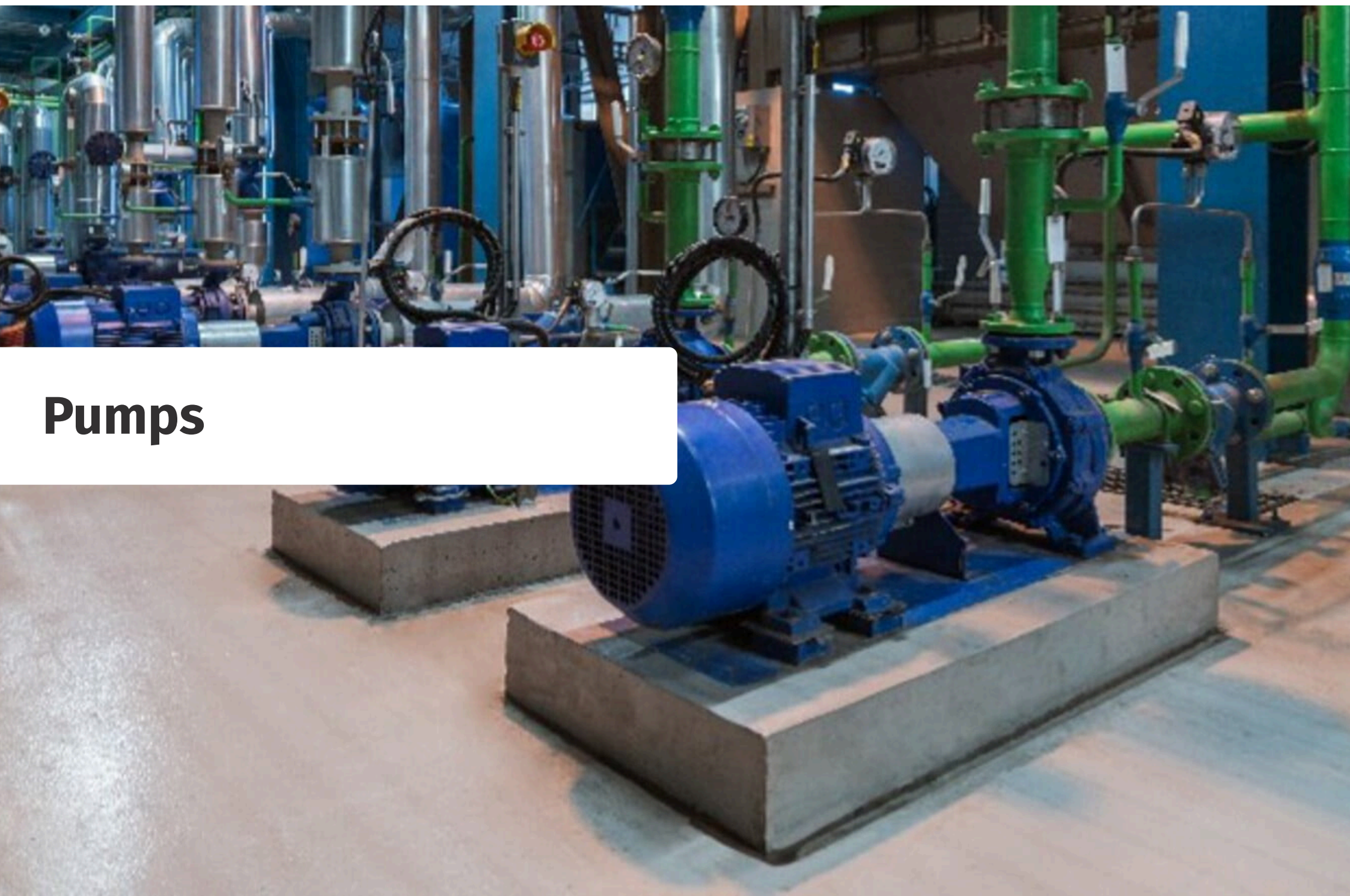

PUMPS

INDUSTRIAL PUMP DESIGN AND MANUFACTURE

East Sussex is a home to a cluster of industrial pump design and manufacture companies. The pumps are used in a diverse range of industries around the world including sectors such as automotive, food production and life science.

EAST SUSSEX SUCCESS STORIES

Edwards based in Eastbourne has over 100 years of heritage and supply innovative products in diverse sectors, from the generation of power to the production of steel, to the challenging environments of space simulation and high energy physics research.

For nearly 30 years Aspen Pumps based in

Hailsham has championed innovation that make the engineer's life easier. Founded in 1992, the Group has evolved into a modern global business and has been winners of the Queen's Awards for Enterprise (2009), Innovation (2012) and International trade (2019).

In 1947, the very first sealless magnetic drive pump was developed by HMD Kontro in Eastbourne, breaking new ground in pump and fluid handling technology, for both general use and for handling hazardous or environmentally threatening liquids.

Fristam pumps based in Hailsham develops reliable solution for numerous industrial processes in the food and beverage, cosmetics, pharmaceutical and chemical industries.

Wright Flow Technologies operating from its offices in Eastbourne is a global hygienic pump solution company. Wright Flow Technologies is dedicated to solving the pumping problems of food, beverage, biotech and pharmaceutical manufacturers worldwide.



Food & Drink



FOOD AND DRINK

The Food and Drink Federation (FDF) list the UK food manufacturing sector as the largest manufacturing sector in the UK, **food and drink comprises 17% of all UK manufacturing.**



The industry has a turnover of more than **£105 billion, employing over 430,000 people.** According to the Government's 2016/2017 review of family expenditure, the average family household in the UK spent £43.18 per person per week on food and drink, including eating out.

CURRENT MARKET OUTLOOK

The FDF noted in its 2020 Food and Drink industry report that in **2018 food and drink export figures were worth more than £23 billion.** In fact 97% of the UK's 7290 food and drink companies are SMEs. The UK's highest value exported products that saw significant growth over recent years include whisky, salmon, wine, gin and pork.

WINE

Plumpton College in East Sussex is acknowledged around the world as a centre for excellence in wine, offering distinguished industry training for the cultivation of vines and production of wine. Plumpton boasts 10 hectares of vineyards producing in excess of 40,000 bottles of award-winning still and sparkling wines each year. When coupled with the purpose-built Wine Centre which includes a commercial winery, research winery, laboratories and a sensory evaluation room, it is no surprise that students travel internationally to study there.

BEER

Beer in the UK can be broadly segmented into three groups: ale, lager and stout. Historically the majority of beer produced in the UK until the 1960s was ale or stout. However, the popularity of lager has increased

dramatically since the 1970s and it now accounts for over half - approximately 64.2% - of all beer produced in the UK. Ale and especially craft ale, has however enjoyed a revival over the past five years and is expected to account for an increasing share of industry revenue as demand for high-quality and craft ales gathers pace.

KOMBUCHA

Kombucha (a fermented tea that is naturally sweet and lightly carbonated with a slightly sour taste) is on the rise in East Sussex and is an industry that is set to grow 209% year on year according to The Grocer.



SUSSEX SUCCESS STORIES

St Leonards based BD Foods has developed a niche, developing partnerships with major national names, driving demand for hand crafted, artisan, innovative accompaniments.

Mamoosh, an artisan baker of contemporary bread and pittas, based in Newhaven supplies restaurants and shops throughout Sussex, recently branching out further afield to supply as far as Newcastle Upon Tyne.

Harvey's Brewery in Lewes is the oldest independent brewery in Sussex. Harvey's produces cask-conditioned, kegged, canned and bottled ales from their brewery on the banks of the river Ouse shipping all over the UK.

Started in 2017, Harley House Distillery in Seaford is well known for its innovative, colour changing Sussex Blue Gin, which turns pink when mixed with tonic. As well as producing Gin the company also has a range of Rum and is expanding.

-
- **SOURCE:** <https://www.fdf.org.uk/publicgeneral/FDF-GT-Exec-Summary.pdf>
 - **SOURCE:** <https://www.fdf.org.uk/statsatagance.aspx>
 - **SOURCE:** <https://www.gov.uk/government/publications/family-food-201617/expenditure>
 - **SOURCE:** https://www.mintel.com/global-food-and-drink-trends?gclid=EAlaIqObChMIh6CB5cGS6QIVDevTCh1RtAPbEAAYASAAEgIDEvD_BwE
 - **SOURCE:** <https://www.statista.com/statistics/1062104/number-of-vegans-in-great-britain/>
 - **SOURCE:** https://www.fdf.org.uk/corporate_pubs/FDF-Industry-Report-2020.pdf

Locate East Sussex

LOCATE
EAST SUSSEX

>LOCATE EAST SUSSEX

Locate East Sussex helps support businesses moving into the county. We provide business support services to help companies reach new levels of productivity, investment and make valuable connections between companies and local planning and economic development teams.

An expert team complemented by an extensive network, we work in partnership with a network of organisations to ensure the companies we work with get the very best help and assistance that they need to start or move a successful business in East Sussex. Our partners include local planning and economic development teams, Business East Sussex, Green Growth Platform, University of Sussex and University of Brighton, to name a few.

A BESPOKE PACKAGE

Our dedicated team provides clear, impartial advice and a practical support package to businesses. Our services are focussed on ensuring you receive support tailored to your company's specific business needs. Whatever size or stage your business is at, we can help you with the right information, the right network and the right support.

BUSINESS RELOCATION AND SUPPORT

If you are looking, we will help you to find the ideal location or new premises including office space, workshop or studio space, factory units, warehouses, incubation and co-working spaces.

FUNDING

We have direct access to various business loan schemes. If you are eligible, we will support you to access these sources of funding to launch a new product or service, expand or

relocate your business, buy new equipment, refurbish your current or new premises and create jobs.

Our activities are focussed on helping to attract new business investment to support the economic growth of the county.

The south east plays a pivotal role in the UK economy and is the gateway to mainland Europe. Locate East Sussex is key to ensuring that East Sussex remains an exceptional place to live, work and visit.

GET IN TOUCH:

◆◆ enquiries@locateeastsussex.org.uk

◆◆ +44 (0)0300 343 5749

◆◆ Freedom Works, 1-3 Robertson
Street, Hastings, TN34 1 HN

◆◆ www.locateeastsussex.org.uk

Focus SB

Case Study

Focus SB

One company taking the lead on exporting is luxury electrical accessory manufacturer Focus SB.

The Hastings-based company claimed a British and European first this year as the only UK manufacturer in its industry to export British-made premium products directly to China.

Focus SB is now representing Britain in China and at the same time providing the company and its 60+ workforce with security following the Brexit vote. This success is also creating opportunities for other companies in East Sussex.

Focus SB were clear that they never felt that they had to compromise their own high standards to meet the growing Chinese market and increasing demand for its premium ranges - designed to complement elegant period properties and to meet aesthetic demands of UK architects and interior designers. However, to win the contract, the company needed to develop a range of products to meet stringent Chinese standards ('CQC'), this involved having their factory audited by Chinese representatives.

In order to prepare for the audit, business manager Adam Berger from Locate East Sussex helped the company to secure funding through East Sussex County Council's grants and loans programme. The company was then able to introduce a testing facility and hire five new staff to run this facility.



[READ THE CASE STUDY HERE!](#)

“

"It was risky, we had to design a range from scratch, which is quite an investment. But the reason we did it is because China is a huge market"

Gary Stevens, Managing Director

✕ [in](#) [f](#)

Scientifica

Case Study



Scientifica

Scientifica is an established global enterprise based in Uckfield, East Sussex, and a world-leading manufacturer of scientific instrumentation, supplying the neuroscience and life sciences markets.

Scientifica is part of UK-based Judges Scientific Plc and started its high growth by designing a new type of micromanipulator used by electrophysiologists. From the beginning, Scientifica has been constantly innovating within this space as well as moving into multiphoton imaging and optogenetics.

The company's products are key to improving our world as the majority of Scientifica's consumers are academics carrying out research into how the brain works. Academics are also involved in more applied investigation areas such as Alzheimer's Disease and Parkinson's.

Scientifica has achieved many notable awards including the Queens Award for Enterprise and the Export Business of the Year from the Chamber Business Awards 2016. These achievements not only measure Scientifica's success but also maintain its status as a leading organisation dedicated to progression in neuroscience research.

Scientifica's products are now distributed to research laboratories and pharmaceutical companies worldwide and are growing a large and enthusiastic customer base internationally. Scientifica's reach extends to more than forty countries, from the United States of America to Japan and Russia - the largest market for consumers being in the US.



"Our vision is to become the world's most trusted provider of advanced imaging systems, enabling significant scientific discovery within the neuroscience research community."

Scientifica



Jeavons Toffee

Case Study



Jeavons Toffee

Starting as a small business in their kitchen, Jeavons Toffee is now an award-winning and only vegan toffee manufacturer in the UK.

Growing up in Buckinghamshire, not many teenage boys spent their time making sweets, but Corin Jeavons was one of them. Rediscovering his mum's recipe books on a visit to his parents' home around six years ago, he decided to take a crack at the old recipes again as an adult, except this time adapting them to fit into his vegan lifestyle.

Trying to recreate the taste of home but without using any dairy is a tough task, and what started as a pastime became a mission to create the perfect toffee, and the beginning of something special. 'We invited some friends over to try them out and they were shocked'

Lesley, Corin's partner in both business and life, said excitedly, 'If they hadn't known where we stood on using animal products, they would have thought they were tricked into eating traditional toffee!'

As soon as they started exploring and creating these new recipes, they resulted in entire product lines of delicious treats. Many Jeavons creations are not aiming to 'veganise' high street brands, but rather aim to create new twists from their own chocolate and toffee factory of ideas.



[READ THE CASE STUDY!](#)

"When we had a look (into Newhaven), we found out it was significantly more affordable and just the right space we needed!"

Lesley Jeavons, Co-Founder

✕ [in](#) [f](#)

Hello Flamingo

Case Study



Hello Flamingo

With help from Locate East Sussex, Hello Flamingo, an award-winning creative design and props manufacturer from Brighton, has moved its production facilities to Newhaven.

Hello Flamingo creates wonderfully unique immersive displays and props for clients such as Joseph, Barbour and Ted Baker, that stand out and make shopping and exhibitions a more interactive and exciting experience. Co-founders Paula Bestford and Roo Solis, started the company five years ago to meet a growing need for more experiential retail experiences.

People value great quality design, and their success proves that, whether in the events industry or in retail. Self-funded from the start, it has managed to build a varied portfolio quickly, investing in new machinery and completing small and large scale projects with companies like De Beers, Habitat and Playstation.

Building a reputation for quality design and finishes, Hello Flamingo has been able to offer competitive services in-house to create permanent spaces or pop-up shops. From design and project management to the manufacturing of permanent installations or temporary window displays, they turn clients' ideas into reality.

Emily Maben of Penhalgion's commented: '...From transforming the roof terrace at Harvey Nichols into a magical garden to creating fragrance display units and window schemes for our boutiques...(they obtained) the perfect mix of creative and commercial'.



“**"With triple the size of our old workshop we've been able to expand and make the place our own!"**

Paula Bestford, Creative Director

✕ [in](#) [f](#)

English Soap Company

Case Study



English Soap Company

From starting in a kitchen in 2000, to now employing nearly 50 people in the heart of the Wealden countryside, the award-winning English Soap Company has grown to become one of the UK's premier soap manufacturers, with a large international presence in the US, Australia and even Japan, winning awards such as Export Award at the Insider Made in the South East Awards 2020.

By combining modern technology with traditional methods, Bob Butts had found a way to create premium quality soap and build a successful business. The English Soap Company was founded on the principle of creating the best product for its customers, and in the world of soap that meant good packaging, great fragrances and competitive prices. Oliver came into the business at a critical time in the late 2000s, taking on the role of Managing Director, working closely with his father, mother and his wife Ailsa.

Based in Waldron, the English Soap Company has grown its manufacturing base from a team of two to a team of 45. Being local has its benefits, but critically, having space to grow has allowed the business to solidify and increase output.



[READ THE CASE STUDY!](#)

“We never shouted about our sustainability at the beginning; we just stuck to what we believed since the start; that it is not the main point, but a natural accepted progression. We are proud to be an ethical and responsible company.”

Oliver Butts, Managing Director

[X](#) [in](#) [f](#)

Torr Scientific Limited

Case Study



Torr Scientific Limited

Previously located in Brighton, Torr Scientific (TSL) moved its business to Bexhill-on-Sea with the help of Locate East Sussex to match high demand. The company works in research institutes, pharmaceutical and environmental industries as well as contributing to space satellite applications.

Managing Director, David Bates said: "The rural location of East Sussex and its proximity to the sea provide a healthier and stress relieving work location. East Sussex has a high density of vacuum technology companies which is what attracted us here.



"East Sussex has a high density of vacuum tech companies which attracted us here... Locate East Sussex helped us find the ideal location for our business."

David Bates, Managing Director

 [in](#) [f](#)

Thank you for reading

Manufacturing and Engineering Sector Proposition

For more information please visit www.locateeastsussex.org.uk